

Vacuum Cleaner for Oscillating Plaster Saw



Item numbers

RU 6220-60	RZ6220-61	RZ6220-62
RZ6220-63	RZ6220-64	RZ6220-65
RZ6220-66	RU 6220-51	

Scope of Delivery

RU 6220-60	Vacuum cleaner without accessories
RZ6220-63	Paper Filter Bag
RZ6220-65	Flat Folding Filter
	Instructions For Use

Intended use

- This equipment is intended for suction/vacuuming of fine, dry cast cutting dust.

Warnings and precautions

- All Safety Information in this Instruction Manual is marked with a 
- Before usage read this Instruction Manual as well as the respective National Industrial Safety Regulations and act accordingly. Please save this Instruction Manual for use at a later time and enclose them when the device is either given or further sold.
- The flat folding filter should never be removed during suction/vacuuming.
- Do not rivet or screw any shields and signs onto the device. The safety insulation can then become inoperative. Adhesive shields are recommended.

- Only use intact plugs and cables. Regularly check cables and plugs.
- Main voltage and voltage information must correspond with one another.
- Only use original RUDOLF Medical accessories.
- Wear personal safety equipment, safety goggles, ear protection and gloves.
- The device should not be operated in areas where there is danger of explosion.

Operation

Manuel Operation

-  The flat folding filter should never be removed when suction/vacuuming

Installation of the paper filter bag

- Remove the top/lid of the dust removal/vacuuming unit
- Insert the paper filter bag
- Re-attach and lock the top/lid of the dust removal/vacuuming unit

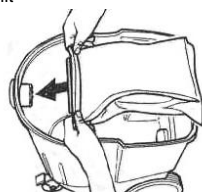

Operation

- Insert the main plug
- Switch on the device and begin operation

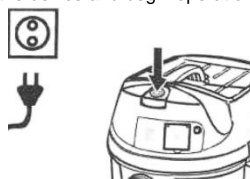

Automatic Operation

- Put the main plug of the Oscillating Saw into the Dust Removal System (3)
- Switch on the Dust Removal System (1)
- The lamp is on – Dust Removal System is now in a Standby-Mode (2)

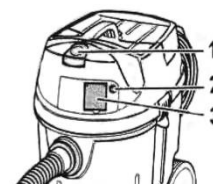

Caution

- The Dust Removal System is automatically switched on and off with the Oscillating Saw
- The Dust Removal System has a starting delay of up to 0.5 seconds and a shutdown delay of up to 15 seconds.
- Voltage information of the Dust Removal System must correspond with the voltage information of the Oscillating Saw.

Cleaning of the Filter (Power Filter Clean)

- The Dust Removal System has a new revolutionary filter cleaning system – especially helpful with fine dust. To clean the flat folding filter, proceed as follows:
 - Remove the Dust Removal/Suction Tube from the Dust Removal Unit
 - Disconnect the main plug of the Oscillating Saw
 - Switch on the Dust Removal System/vacuum
 - Using the palm of your hand, hold the opening of the Dust Removal/Suction Tube closed for several seconds
 - The flat folding filter is cleaned through automatic blasts of air (pulsating sound)

-  During operation as well as at the conclusion of operation, activate the Power Filter Clean at regular intervals.

Switching on of the Power Filter Clean

Position Slide (1) – slide it downwards



Switching Off of the Power Filter Clean

Position Slide (1) – slide it upwards



Care and Maintenance

-  Always disconnect the main plug beforehand when working on the Dust Removal System.

Changing of the Flat Folding Filter

- Open the cover of the filter
- Change the Flat Folding Filter), respectively, the exhaust filter
- Close the cover of the filter, you must hear how it clicks into place

Cleaning of the Electrodes

- Unlock and remove the top/lid of the Dust Removal System
- Clean the electrodes
- Re-attach the top/lid of the Dust Removal System and lock it

Troubleshooting

Suction turbine does not run

- Check the cable, plug, fuse and outlet
- Switch on the device

Suction turbine turns off

- Empty the container

Suction turbine does not run again after the container was emptied

- Switch off the device and wait 5 seconds, then after 5 seconds switch on the device again
- Clean the electrodes as well as the space between the electrodes

Suction power decreases

- Remove the blockage from the Dust Removal Unit, suction tube or flat folding filter
- Change the paper filter bag
- Cleaning of the Filter: Power Filter Clean (see Chapter 6)
- Correctly click in the cover of the filter
- Change the flat folding filter

Dust discharges during suctioning/vacuuming

- Check to see that the flat folding filter is properly inserted
- Change the flat folding filter

Power Filter Clean continually switches on and off

- Remove the blockage from the Dust Removal Unit, suction tube or flat folding filter
- Change the flat folding filter

Accessories

RU 6220-51	Complete Set including RU 6220-20
RU 6220-61	Retrofit Set without Cast Cutting Saw
RU 6220-63	Paper Filter Bags 5 each
RU 6220-64	Wet Filter Bags 5 each

Spare Parts

RU 6220-62	Replacement Tube complete; 2 meters
RU 6220-65	Flat Folding Filter
RU 6220-66	Flat Folding Filter HEPA-Norm
RU 6220-67	Hanger Fixture for oscillating plaster saw RU 6220-20 and RU 6220-22

Guarantee

- We guarantee our Dust Removal System according to the legal and national specific regulations (proof via invoice or delivery note). The guarantee period is for a minimum of two years. In the case of material- or production discrepancies, we accept a no-charge repair of the device. This guarantee becomes invalid should an individual attempt to repair the device. Damage due to improper handling, over-stressing or by normal wear and tear are not covered in the guarantee. Please contact our customer repair department. In the event of a guarantee- and repair, please include a copy of the invoice or of the delivery note when the device is returned.

Environmental Protection

- Environmentally recycle the packaging, disused devices and their accessories. Further information can be obtained by your dealer.

Technical Data

Model	RZ6220-60
Mains Supply	230 Volt, 50/60 Hz.
Power Rating	1200 Watt
Type of Current	1 ~
Vacuum	235 mbar
Air Volume	57 l/s
Container Volume	35 l
Filter Performance	99,97% > 0,5 µm
Noise Level	63 dB
Weight	9,5 kg
Safety Class	II 

CE-Conformity

- We hereby state in sole responsibility, that this product corresponds with the following Norms or Normative Documents: EN 60601-1-2 according to the regulations of the Guideline 89/336/EWG and 93/42/EWG.

Attachment

Initial Operation

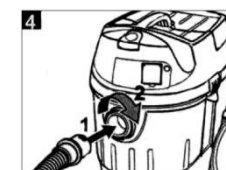
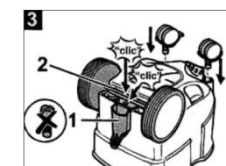
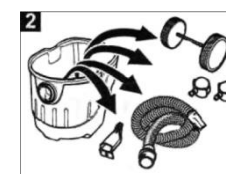
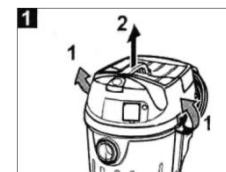

Parking Brake

